



# Products

PX-I Smoke Alarm Device

PX-IC Radio-Linked Smoke Alarm Device

PX-iP Gateway | PyrexX App





# Confidence by Outstanding Quality

Due to our experience as a service provider and manufacturer, we have implemented and developed a completely new Generation of high-quality smoke detection systems.

Each smoke alarm device manufactured by Pyrex Technologies meets the requirements of the German TUV and KRIWAN quality matrix as well as the product standards CE EN 14604 and the Q-Label.







# The Best Long-Term Smoke Alarm Device

The PX-1 is a long-term smoke alarm, with a non-removable Lithium Battery, that has a life span of 12 years. This means that you no longer have to worry about annoying and expensive battery replacements. Therefore we actively contribute to the preservation of the environment.

Under normal conditions of use and maintenance, we grant a warranty of 12-years on the battery and the electronics. The PX-1 has a sensor-controlled safety mechanism, where an alarm is only triggered when there are significant signs of a fire. Our products achieve the highest false alarm protection.



# Long Range Radio-Linked Smoke Alarm Device

Our wireless products can easily be connected with each other and they react simultaneously when an alarm is triggered. What good is a smoke alarm that is installed in the basement or attic, if the alarm can not be heard in your bedroom!

The PX-1C is suitable for very large and multi-storied houses as well as for residential units. Our radio-linked smoke alarms are also equipped with lithium batteries that have a life span of 10 plus 2 years, which makes annoying battery replacements unnecessary.





## Smart Safety Wherever You'll Need It

The PX-iP Gateway expands our wireless smoke alarms to an internet-enabled smoke detection system. Thus you are always informed about the security status at home. We send you alerts right when you need them.

You will receive real time notifications on your smartphone, tablet or on your personal computer. The alerts contain the cause of the alarm, the battery life, the temperature and the contamination level as well as the exact location of the smoke alarm.

Once activated and configured by using the Pyrex App, the device automatically connects to your home Wi-Fi network. In case of power or internet outages, the PX-iP Gateway features a back-up battery and a GSM module with a SIM card.



# Security Software for Smoke Alarm Devices

The simply designed Pyrex App allows the user to configure and control various functions of the PX-iP Gateway. The Pyrex App is optimized for smartphones and tablets, and is also available as a Web App for your personal computer.

Moreover the user friendly interface of this App helps you document your maintenance of the devices and also assists you in creating protocols for your annual documentation.



# Certified Adhesive Gel-Pad Installation



The scope of delivery of every Pyrex Smoke Alarm includes a magnetic carrier system with a special adhesive Gel-Pad. With our unique and certified installation method, you can securely install all Pyrex smoke alarms to any ceiling structures.

Mounting of the device by screwing it onto your ceiling is also possible and included in the packaging.



# Simple Annual Device Maintenance

The smoke alarm legislation often requires an annual maintenance of the devices in your home.

You can easily examine Pyrex smoke alarms by pressing the Test/Stop button for example with the help of a broomstick. When contaminated, you can quickly remove the smoke alarms from their magnetic carrier to clean it with ease.

If you want to use the Pyrex Smoke Detector Test Spray for the maintenance of your smoke alarms, we kindly ask you to contact one of our authorized resellers.

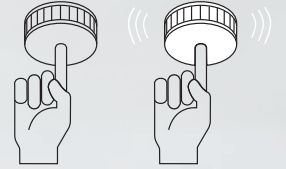

## Minimum Residential Requirements

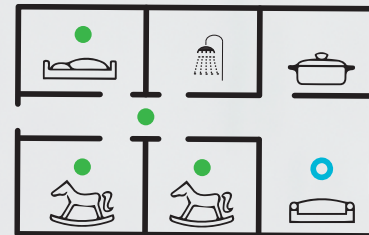

● Necessary    ● Recommended





# Beautiful Individual Design

Pyrex quality smoke alarms combine modern electronics with innovative features along with absolute reliability and timeless design. The casing design has no disruptive elements such as special probes or unnecessary LED lights.

The lower part of the smoke alarms functions as the Test/Stop button, which can easily and safely be reached in case of an alert.

Only Pyrex products can be visually customized to everyone's aesthetic preferences. Our smoke alarms can therefore adapt perfectly to everyone's individual design concepts.







# Unique Colouresque Variety

Do you have a favorite colour?

Every person is unique and colour represents individuality.

In order to satisfy everyone's tastes, we are the only manufacturer that offers high quality smoke alarms in numerous colours and colour combinations.

Our wide variety of colours ranges from gold and silver to our wooden edition as well as the Swarovski Elements® smoke alarms.

For a complete overview of all our coloured smoke alarms, please visit our website:

[smoke-alarm-device.com](http://smoke-alarm-device.com)

# Technical Specifications

## PX-I Smoke Alarm Device

- CE, EN 14604, ROHS, German TUV
- Made in Germany
- max. 12 years of battery life (lithium)
- Bi-sensor processor technology (smoke + heat)
- Certified magnetic carrier system with special adhesive gel pad
- Maximum false alarm protection
- Kitchen suitable
- Insect Shield
- Alarm signal > 85 dB
- max. 60 m<sup>2</sup> detection range
- Large and simple to use Test/Stop button (78 cm<sup>2</sup>)
- No battery change necessary
- Intelligent software analysis of sensor readings (Processor technology)
- Cyclical genuine self-test function
- Help signal (e.g. low battery status or contamination)

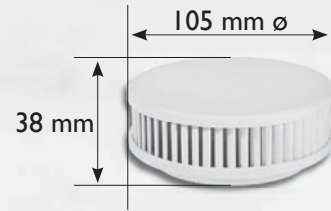

## PX-IC Radio-Linked Smoke Alarm Device

In addition to the specifications of the PX-I:

- Radio interconnectable
- Frequency: 868.3 MHz
- Protocol: FSK (Frequency Shift Keying)
- Maximum number of interconnected devices: 15
- Max. 14 subgroups possible
- Radio range: 400 m ( $\pm 10\%$ ) in the open field
- Repeater function

## PX-iP Gateway

- 32-bit processor
- Radio interconnectable with PX-IC
- Frequency 868.3 MHz
- Protocol: FSK (Frequency Shift Keying)
- Wi-Fi, GSM (Backup function)
- Operated via Pyrex App (Web, Android and iOS)
- Power supply

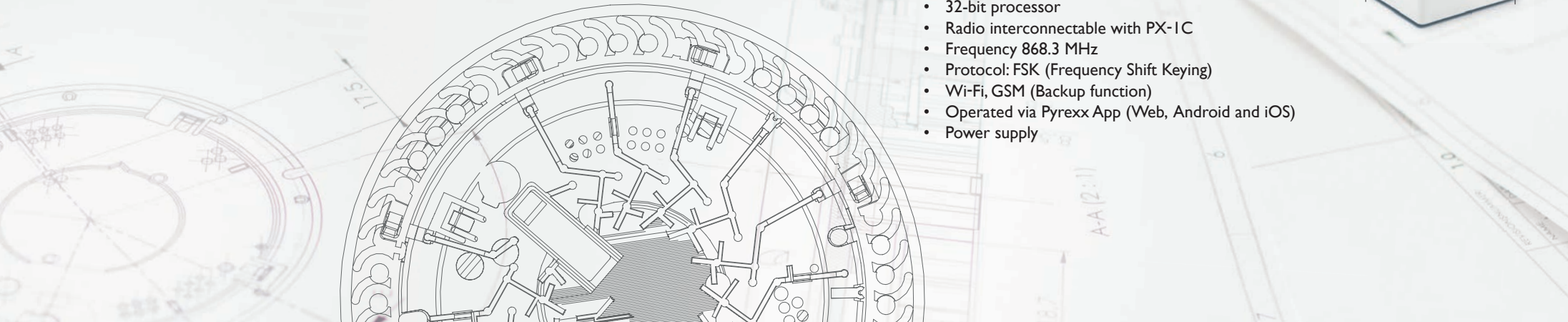
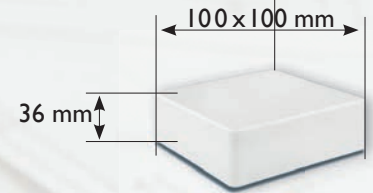





PyrexX

Spichernstr. 2  
10777 Berlin

Germany

T +49 30 8871 6060  
info@pyrexX.com

pyrexX.com